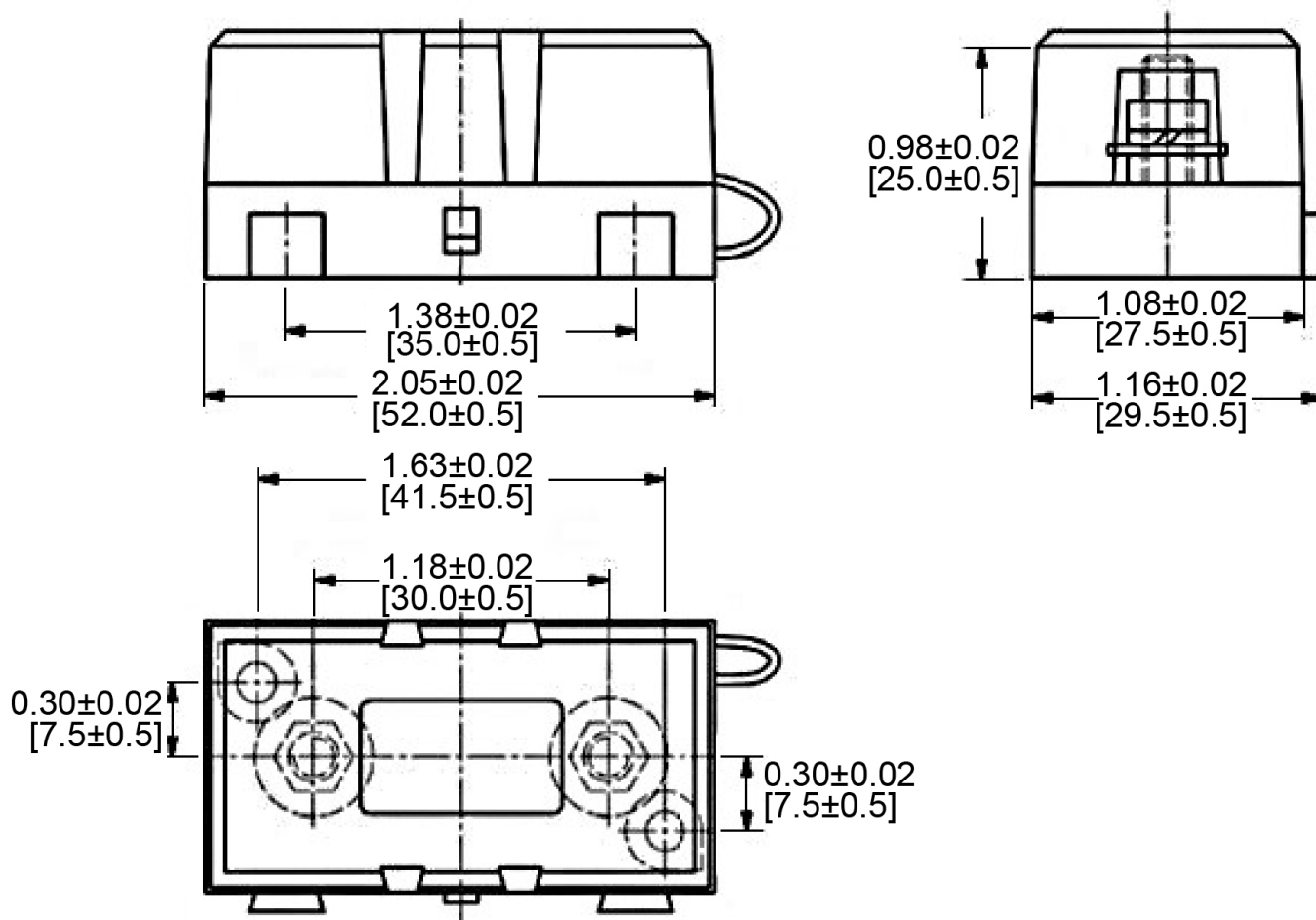

Mechanical Dimensions: Inches [mm]

Tolerances ± 0.012 [0.3] Unless Otherwise Specified

Electrical Specifications

Voltage Rating 80VDC

Max Fuse Rating 200A

Material Specifications

For MID/MIDA Limiter Fuses

Body Material Nylon 66 (UL94V-0)

Cover Material Nylon 66 (UL94V-0)

Transparent Window PC

Terminals M5 Threaded Studs with Hex Nuts and Lock Washers

Interconnecting pins on the side of the fuse holder allow for multiple blocks to be configured together

Automotive Bolt On Fuse Holder
(MIDI Style)

BLC-61

Rev	Date of issue	Revision Notes	Designed	Approved
C	12-05-2024	Initial Drawing	RC	OF