

Type FSG-G
Automotive Glass Fuse
13/32" x 1-1/2" (10.3 x 38.1mm)



www.optifuse.com (619) 593-5050

Fuse Size: 13/32" x 1 1/2" (10.3 x 38.1mm)

Agency Standards and Listings:



Ampere Rating: 1A ~ 80A

Voltage Rating: 32V AC/DC

Time Characteristics:			
Rated Current	100%	135%	200%
	Min.	Max.	Max.
1A – 30A	4h	1h	120s
35A-80A	4h	1h	

Interrupt Rating: 1000A, 32 VDC

Terminals: Gold plated

Specifications according to UL 248-1, 14

Mechanical Dimensions: Inches[mm]

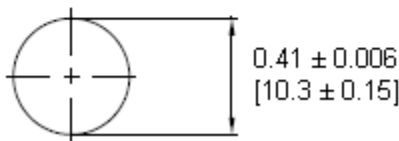
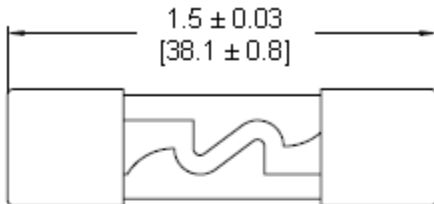

Part Number	Ampere Rating	Voltage Rating
FSG-G-1A	1A	32V AC/DC
FSG-G-2A	2A	
FSG-G-3A	3A	
FSG-G-4A	4A	
FSG-G-5A	5A	
FSG-G-8A	8A	
FSG-G-10A	10A	
FSG-G-15A	15A	
FSG-G-20A	20A	
FSG-G-25A	25A	
FSG-G-30A	30A	
FSG-G-35A	35A	
FSG-G-40A	40A	
FSG-G-50A	50A	
FSG-G-60A	60A	
FSG-G-70A	70A	
FSG-G-80A	80A	

	-Operation beyond the specified maximum ratings or improper use may result in damage and possible electrical arcing and/or flame.
	-Avoid contact of Fuse device with chemical solvent. Prolonged contact may damage the device performance.