

Type LPM-05

Water-Proof In-Line Fuse Holder

Automotive Mini. Blade Type



www.optifuse.com

(619) 593-5050

Specifications:

Rating: 125VDC

Body/Cap Material: Polycarbonate

Seal Material: Silicon rubber

Contacts: Bronze, Tin/Nickel plated

IP Rating: IP67

For use w/ Type APM, ANR Fuse (Miniature Automotive Blade)

Water-proof with Inter-Locking Cap

Attached Mounting Bracket

Standard Wire: #12, #14, #16 AWG – 12” Loop - Red Color
(Other wire sizes and colors available as special order)

Part number format

LPM-05B-##R

Where

= Wire Gauge (12,14,16 AWG)

Wire Gauge	Max. Amperage
12 AWG	30 A
14 AWG	20 A
16 AWG	15 A

Mechanical Dimensions: Inches [mm]

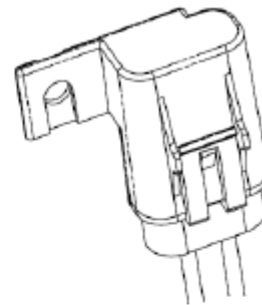
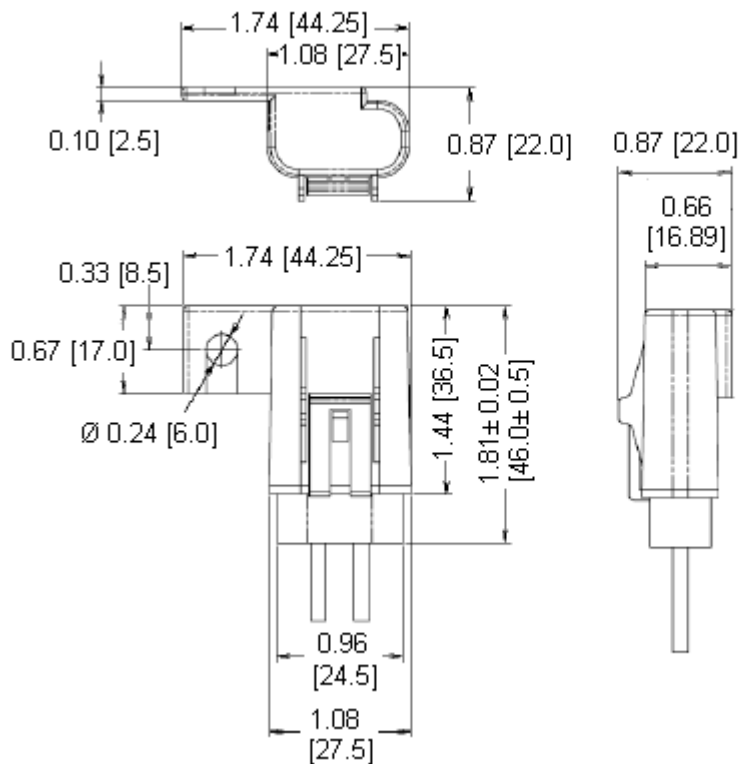

Warning:



- Operation beyond the specified maximum ratings or improper use may result in damage and possible electrical arcing and/or flame.
- Device are intended for occasional overcurrent protection. Application for repeated overcurrent condition and/or prolonged trip are not anticipated.
- Avoid contact of device with chemical solvent. Prolonged contact will damage the device performance.
- Not intended for submersible water applications.

Note: All specifications subject to change without notice.

Rev B 10/2024 - Page:
1/1 Code B01-01H