

Type LPX-02

In-Line Fuse Holder

Maxi Automotive Blade Fuses

Splashproof Cap, Ignition Protected



Ratings:

Fuse Type: Maxi Automotive Blade - APXs,
ANXs **Electrical Rating:** 125VDC
Ambient/Operating Temperature: -40 °C to +85 °C
Body: PVC
Contacts: Brass with Tin Plated
Cap: Splashproof Cap
IP Rating: IP65
Ignition Protected
Standard Wire Sizes: #6 ~ #8 AWG
Standard Wire Colors: See table
Standard Body colors: Black
Standard Wire Length: 5 Inches on Each Side, 10 Inches Total

Available in various wire gauges and lengths, and body and wire colors.
Contact factory for those not listed above.

Mechanical Dimensions: Inches [mm]

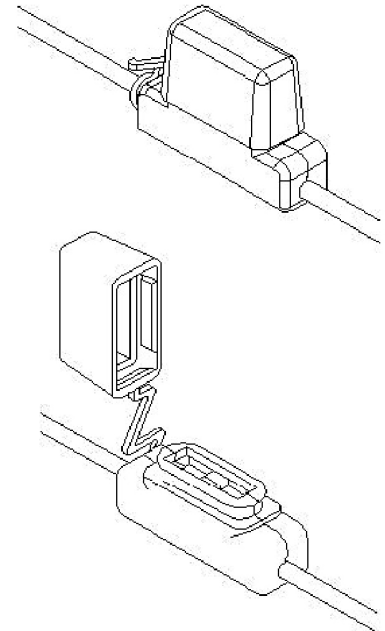
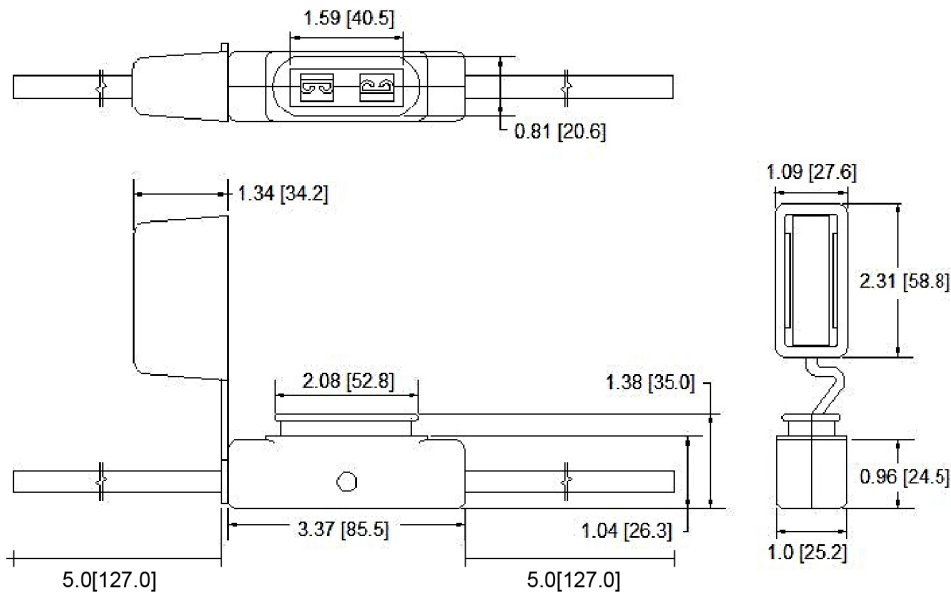

Warning:



- Operation beyond the specified maximum ratings or improper use may result in damage and possible electrical arcing and/or flame.
- Avoid contact of device with chemical solvent. Prolonged contact may damage the device performance.
- Not designed for prolonged liquid exposure or submersible applications.