

Mechanical Dimensions: Inches [mm]

Unless otherwise specified all dimensions ± 0.2 mm

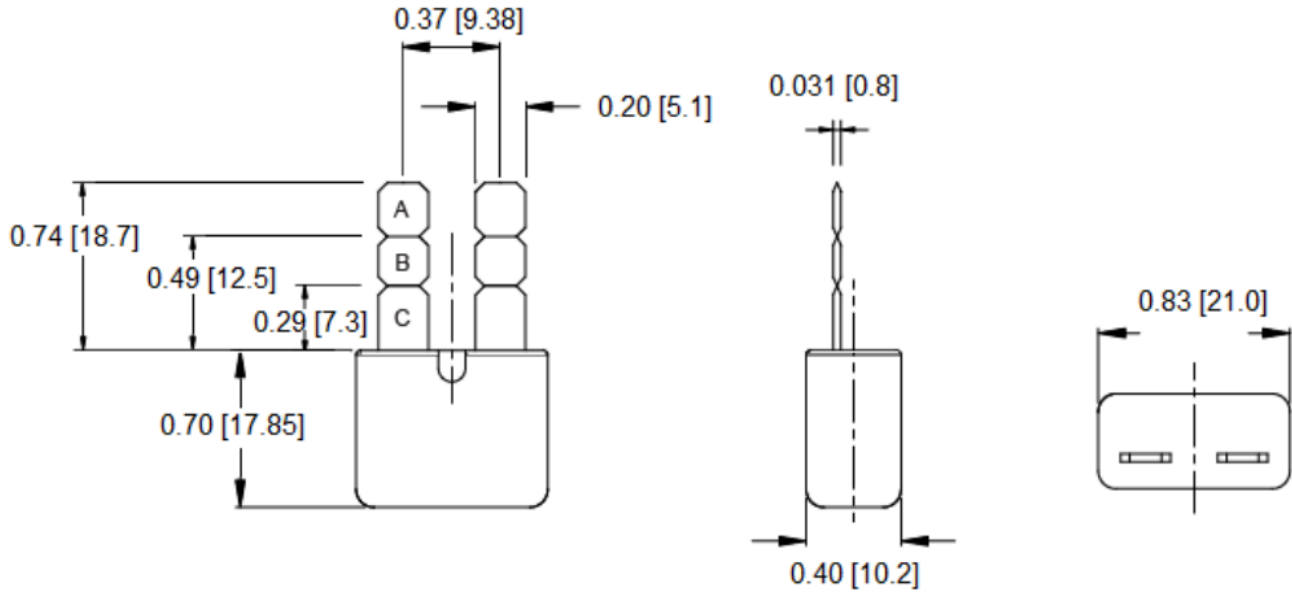

Part Numbers Information

Optifuse P/N	Amperage
MOCB2-PL3-5A	5A
MOCB2-PL3-6A	6A
MOCB2-PL3-8A	8A
MOCB2-PL3-10A	10A
MOCB2-PL3-15A	15A
MOCB2-PL3-20A	20A
MOCB2-PL3-25A	25A
MOCB2-PL3-30A	30A

Electrical Specifications

Voltage Rating	12VDC
Reset Type	Type II - Modified Reset
Operation Temperature	-23°C ~ 65°C
Testing	SAE J553 Type II

Material Specifications

Universal Style Circuit Breaker	
Body Material	Aluminum
Terminals Material	Brass

Time vs. Percent of Rated Current

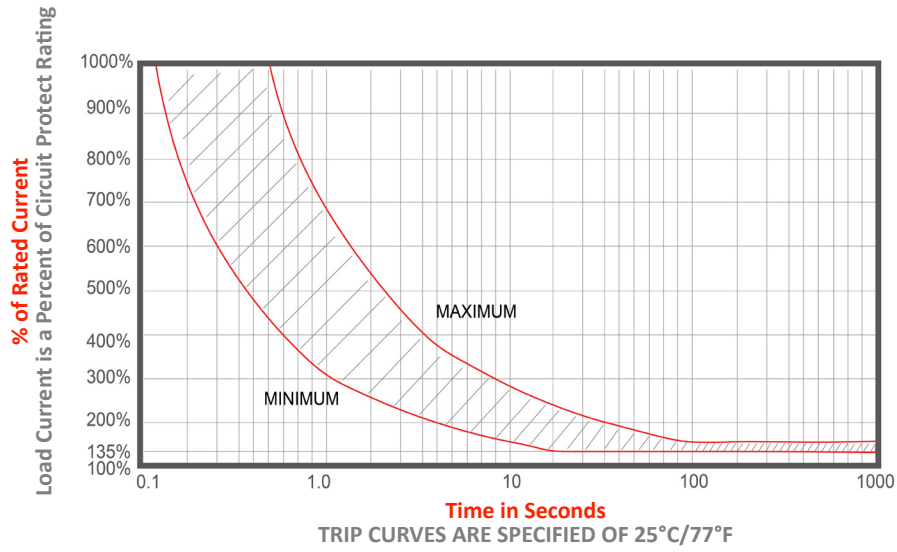

Rev	Date of issue	Revision Notes	Designed	Approved
B	09-15-2023	updated format	RC	OF