

Type PMA-KB-01H-SOS

Panel Mount Fuse Holder

1/4" x 1 1/4" (6.3 x 32mm) Fuses

Knob / Bayonet – High Amp



www.optifuse.com

(619) 593-5050

Electrical Rating: 30A, 250V AC

Fuse Style: 1/4" x 1 1/4" (6.3 x 32mm)

Operation Temperature: -30°C~85°C

Material:

Frame and Cap: Phenolic (UL flame:

94V-1) **Terminals:** Tin-plated brass

Cap: Knob type, Bayonet type

Mounting: by metal nut

Terminal: Solder 5.5mm / 0.230"

Panel Thickness: 0.5 ~ 6.5mm

Agency Approvals and Listings:



Product Dimensions: Inches [mm]

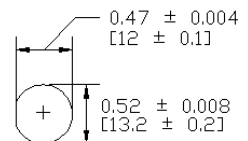
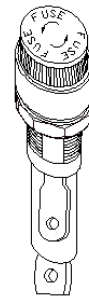
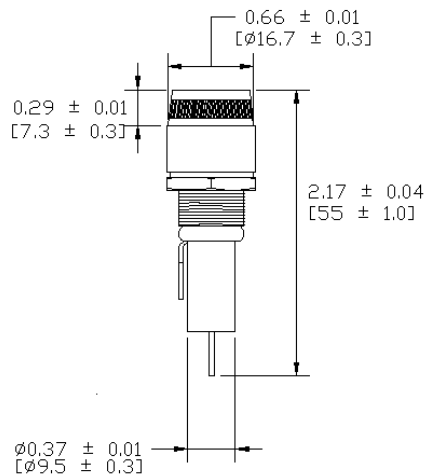
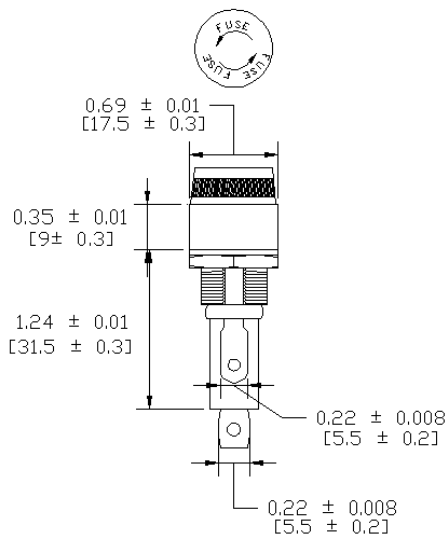

Mounting Hole

Warning:



-Operation beyond the specified maximum ratings or improper use may result in damage and possible electrical arcing and/or flame.

-Fuse Holders are not intended for circuit disconnect. All power should be disconnected before removing fuse.

-Avoid contact of Fuse Holder with chemical solvent. Prolonged contact may damage the device performance.

Note: All specifications subject to change without notice.

Rev B 11/2024 - Page: 1/1
Code S02-02D