

Part Number Information

P/N	Amperage	Voltage	Nominal Cold Resistance (Ω)	Max Voltage Drop (mV) 100% Rated Current	Average I ² T (A ² sec)	Maximum Sustained dissipation (mW) 150% Rated Current
TMR-R-E-50mA	50mA	Blank	6.53	550	0.006447	155
TMR-R-E-63mA	63mA	Blank	3.9	480	0.012907	160
TMR-R-E-80mA	80mA	Blank	2.62	400	0.019062	165
TMR-R-E-100mA	100mA	Blank/1/3	2.05	350	0.02623	170
TMR-R-E-125mA	125mA	Blank/1/3	1.34	300	0.04499	180
TMR-R-E-160mA	160mA	Blank/1/3	0.87	280	0.08755	190
TMR-R-E-200mA	200mA	Blank/1/3	1.22	260	0.1181	200
TMR-R-E-250mA	250mA	Blank/1/3	0.478	240	0.3206	220
TMR-R-E-315mA	315mA	Blank/1/3/4	0.48	220	0.5153	250
TMR-R-E-400mA	400mA	Blank/1/3/4	0.29	200	0.7761	280
TMR-R-E-500mA	500mA	Blank/1/3/4	0.211	190	1.631	310
TMR-R-E-630mA	630mA	Blank/1/3/4	0.146	180	2.329	360
TMR-R-E-800mA	800mA	Blank/1/3/4	0.1035	160	5.145	430
TMR-R-E-1A	1A	Blank/1/3/4	0.0783	140	6.619	500
TMR-R-E-1.25A	1.25A	Blank/1/3/4	0.057	130	12.23	600
TMR-R-E-1.6A	1.6A	Blank/1/3/4	0.0411	120	22.03	730
TMR-R-E-2A	2A	Blank/1/3/4	0.0325	100	43.08	870
TMR-R-E-2.5A	2.5A	Blank/1/3/4	0.0236	100	50.05	1000
TMR-R-E-3.15A	3.15A	Blank/1/3/4	0.0179	100	73.53	1200
TMR-R-E-4A	4A	Blank/1/3/4	0.0134	100	128.3	1400
TMR-R-E-5A	5A	Blank/1/3/4	0.0099	100	176.8	1500
TMR-R-E-6.3A	6.3A	Blank/1/3/4	0.0075	100	309.5	1600
TMR-R-E-8A	8A	Blank/1/3/4	0.005	80	305.7	1800
TMR-R-E-10A	10A	Blank/1/3/4	0.0039	75	439.2	2000
TMR-R-E-16A	16A	Blank/1/3	0.0033	-	585.8	-

*Voltage Code:
Blank=250V
1=125V
3=300V
4=400V

* Designed to Meet IEC Specifications

Agency Standards and Listings

File E197390 (100mA ~ 10A)

Part Naming System

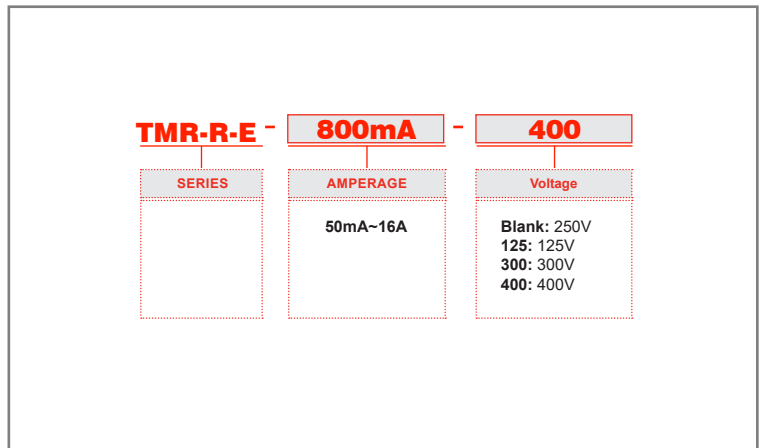

Mechanical Dimensions: Inches [mm]

Tolerances ± 0.012 [0.3] Unless Otherwise Specified

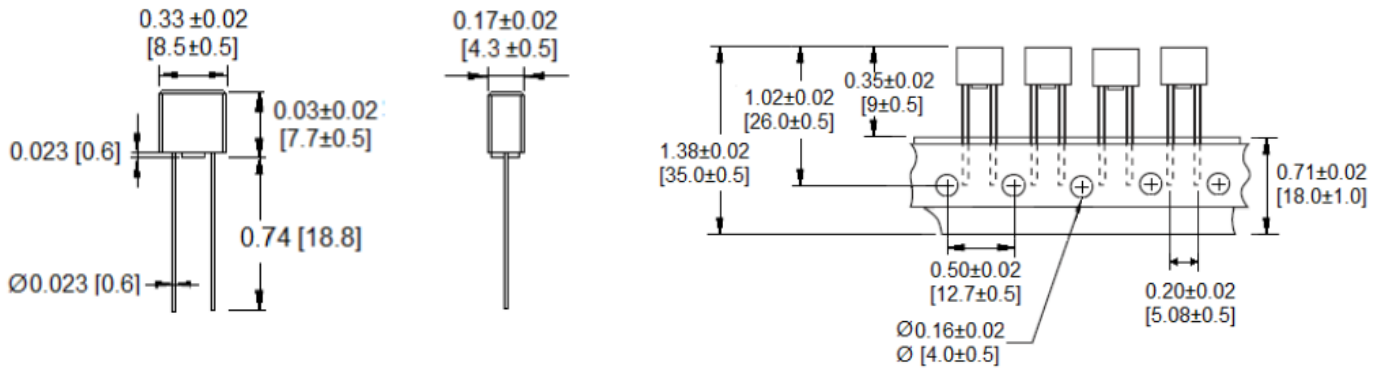

Mounting Hole

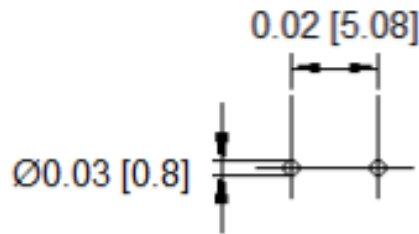

Electrical Specifications

Operating Temperature -55°C ~ +125°C

Packaging On Tape: Ammo Pack, 1,000 pcs per box

Material Specifications

Thermoplastic Body, UL 94-V0

Tin-Lead Plated Alloy Pins

Electrical Characteristics:

%	Min	Max
210%	-	2 m
275%	400 ms	10 s
400%	150 ms	3 s
1000%	20 ms	150 ms

Interrupting Rating:

Rated Amperage	Voltage	Interrupting Rating
315mA~10A	250VAC	130A @ 250VAC
100mA~6.3A	300VAC	50A @ 300VAC
100mA~250mA	125VDC	50A @ 125VDC
315mA~6.3A	125VDC	63A @ 125VDC

Rev Date of issue Revision Notes

Designed Approved

E	02-20-2026	Initial Drawing	RC	OF
---	------------	-----------------	----	----